

글로브 벨로우즈 밸브

BELLOWS SEALED GLOBE VALVE

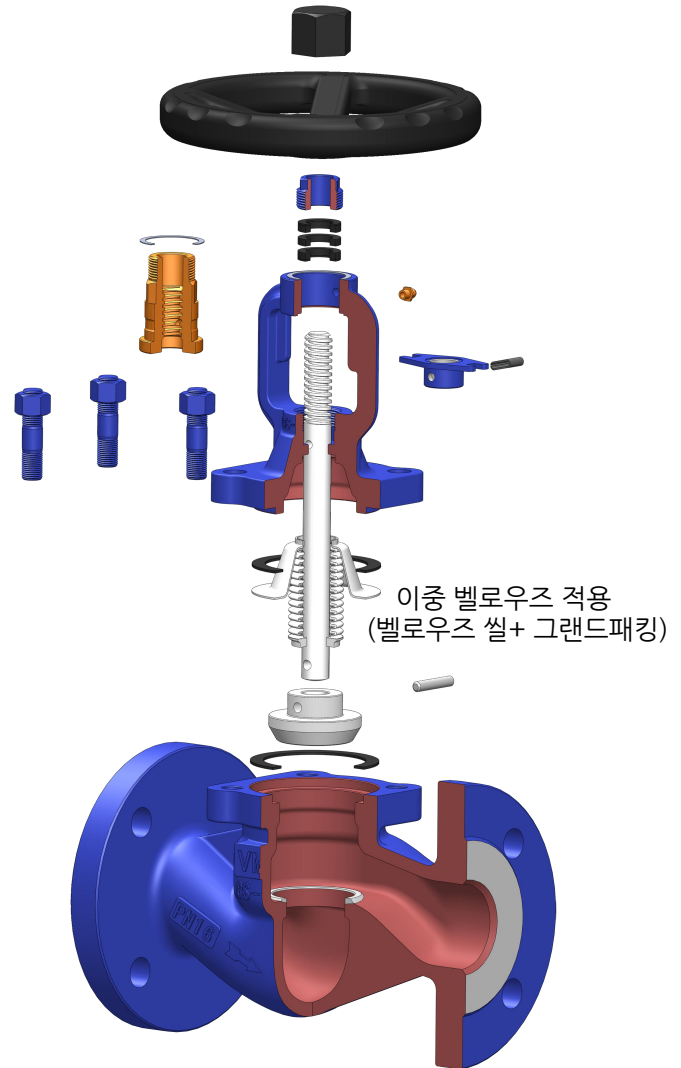

| Body material | Nominal pressure | Nominal diameter | Max temperature |
|-----------------|----------------------------|------------------|-----------------|
| JS1049 (0.7043) | 16 bar 25 bar | DN 15-200 | 350°C |
| GS-C25 (1.0619) | 16 bar 25 bar 40 bar | DN 15-400 | 425°C |
| CF8 (1.4308) | 16 bar 25 bar 40 bar | DN 15-400 | 600°C |
| CF8M (1.4408) | 16 bar 25 bar 40 bar | DN 15-400 | 600°C |

CE 0036

Correspond to the pressure equipment 2014/68/eu annex III Module H

APPLICATION

적용가능한 유체

* 고온의 열매체의 유체

* 스팀용

* 각종 화학 공정

FEATURES

- High tightness (leakproofness class - A acc. EN -12266 - 1)
- Compact settlement
- Environment-friendly
- Test acc.EN-12266-1
- Flanges drilled according to EN-1092-1&2
- Face-to-face dimension according to EN 588-1

Edition 10/2017

제품구조



MATERIALS

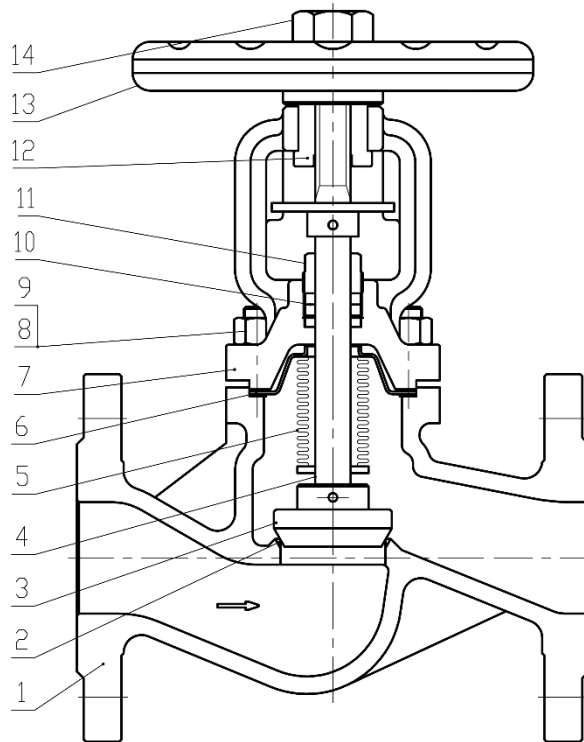

Conical disc

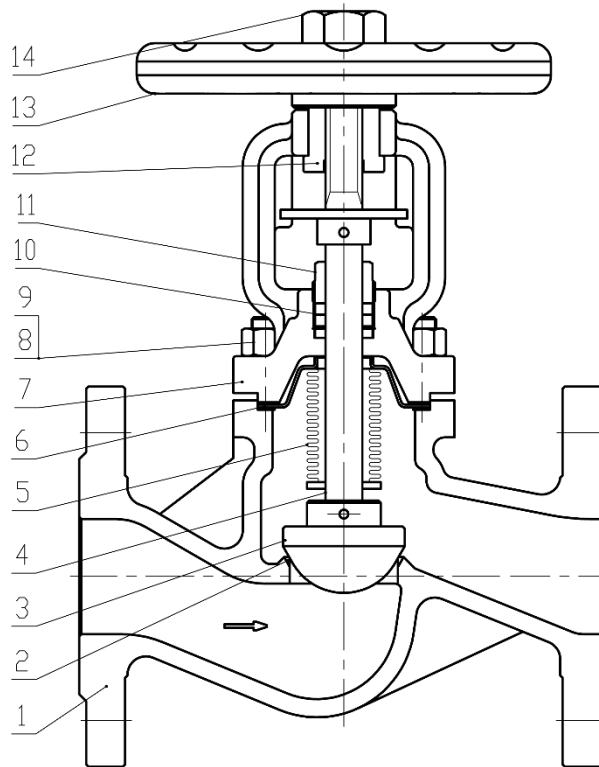

Throttle disc

재질정보



MATERIALS

| No. | Part Name | Part Material | | | |
|-----|-----------------|-----------------|-----------------|------------------|------------------|
| | | | | | |
| 1 | Body | JS1049/ 0.7043 | GS-C25/ 1.0619 | CF8/ 1.4308 | CF8M/ 1.4408 |
| 2 | Seat | X20Cr13/ 1.4021 | X20Cr13/ 1.4021 | CF8/ 1.4308 | CF8M/ 1.4408 |
| 3 | Disc | X20Cr13/ 1.4021 | X20Cr13/ 1.4021 | F304/ 1.4301+STL | F316/ 1.4401+STL |
| 4 | Stem | X20Cr13/ 1.4021 | X20Cr13/ 1.4021 | F304/ 1.4301 | F316/ 1.4401 |
| 5 | Bellows | SS304 | SS304 | SS316L | SS316L |
| 6 | Gasket | Graphite+SS304 | Graphite+SS304 | Graphite+SS304 | Graphite+SS316 |
| 7 | Bonnet | JS1049/ 0.7043 | GS-C25/ 1.0619 | CF8/ 1.4308 | CF8M/ 1.4408 |
| 8 | Bolt | A193-B7 | A193-B7 | A193-B8 | A193-B8M |
| 9 | Nut | A194-2H | A194-2H | A194-8 | A194-8M |
| 10 | Packing | Graphite | Graphite | Graphite | Graphite |
| 11 | Gland | GS-C25/ 1.0619 | GS-C25/ 1.0619 | CF8/ 1.4308 | CF8M/ 1.4408 |
| 12 | Stem nut | 1045/ 1C45 | 1045/ 1C45 | Brass | Brass |
| 13 | Handwheel | C.S | C.S | C.S | C.S |
| 14 | Cap | A105 | A105 | A105 | A105 |
| | Max.temperature | 350℃ | 425℃ | 600℃ | 600℃ |

제품도면



DIMENSIONS

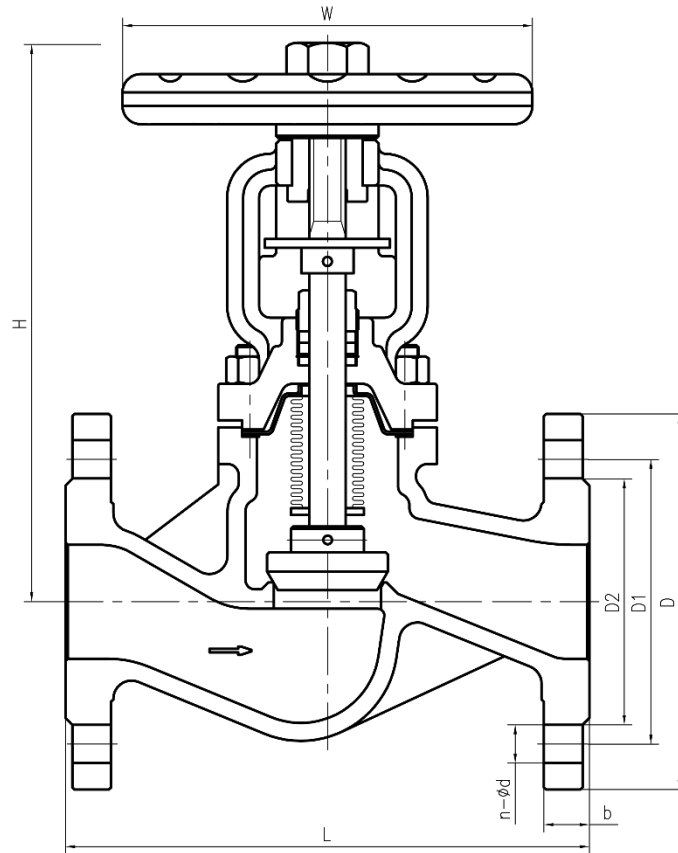

| DN | PN16,25,40 | | | | PN16 | | | | | | | PN25 | | | | | | PN40 | | | | | |
|-----|------------|---------|---------|-------------------------|---------|----------|----------|---------|------------|-----------|---------|----------|----------|---------|------------|-----------|---------|----------|----------|---------|------------|-----------|--|
| | L mm | W mm | H mm | Kv m ³ /h | D mm | D1 mm | D2 mm | b mm | n-ød mm | N.W Kg | D mm | D1 mm | D2 mm | b mm | n-ød mm | N.W Kg | D mm | D1 mm | D2 mm | b mm | n-ød mm | N.W Kg | |
| 15 | 130 | 140 | 192 | 4.7 | 95 | 65 | 45 | 16 | 4-ø14 | 4.2 | 95 | 65 | 45 | 16 | 4-ø14 | 4.2 | 95 | 65 | 45 | 16 | 4-ø14 | 4.3 | |
| 20 | 150 | 140 | 192 | 6.8 | 105 | 75 | 58 | 18 | 4-ø14 | 4.8 | 105 | 75 | 58 | 18 | 4-ø14 | 4.8 | 105 | 75 | 58 | 18 | 4-ø14 | 4.9 | |
| 25 | 160 | 160 | 207 | 11.4 | 115 | 85 | 68 | 18 | 4-ø14 | 6.2 | 115 | 85 | 68 | 18 | 4-ø14 | 6.2 | 115 | 85 | 68 | 18 | 4-ø14 | 6.3 | |
| 32 | 180 | 160 | 207 | 16.3 | 140 | 100 | 78 | 18 | 4-ø18 | 7.8 | 140 | 100 | 78 | 18 | 4-ø18 | 7.8 | 140 | 100 | 78 | 18 | 4-ø18 | 8 | |
| 40 | 200 | 180 | 245 | 29 | 150 | 110 | 88 | 18 | 4-ø18 | 10 | 150 | 110 | 88 | 18 | 4-ø18 | 10 | 150 | 110 | 88 | 18 | 4-ø18 | 10.2 | |
| 50 | 230 | 200 | 253 | 43.5 | 165 | 125 | 102 | 20 | 4-ø18 | 13 | 165 | 125 | 102 | 20 | 4-ø18 | 13 | 165 | 125 | 102 | 20 | 4-ø18 | 13.2 | |
| 65 | 290 | 220 | 295 | 74 | 185 | 145 | 122 | 20 | 4-ø18 | 21 | 185 | 145 | 122 | 22 | 8-ø18 | 21 | 185 | 145 | 122 | 22 | 8-ø18 | 23.5 | |
| 80 | 310 | 250 | 328 | 109 | 200 | 160 | 138 | 20 | 8-ø18 | 26.5 | 200 | 160 | 138 | 24 | 8-ø18 | 26.5 | 200 | 160 | 138 | 24 | 8-ø18 | 28 | |
| 100 | 350 | 300 | 385 | 172 | 220 | 180 | 158 | 20 | 8-ø18 | 43 | 235 | 190 | 162 | 24 | 8-ø22 | 43.8 | 235 | 190 | 162 | 24 | 8-ø22 | 45 | |
| 125 | 400 | 350 | 427 | 277 | 250 | 210 | 188 | 22 | 8-ø18 | 60 | 270 | 220 | 188 | 26 | 8-ø26 | 68 | 270 | 220 | 188 | 26 | 8-ø26 | 70 | |
| 150 | 480 | 400 | 480 | 408 | 285 | 240 | 212 | 24 | 8-ø22 | 87 | 300 | 250 | 218 | 28 | 8-ø26 | 94 | 300 | 250 | 218 | 28 | 8-ø26 | 96 | |
| 200 | 600 | 450 | 672 | 708 | 340 | 295 | 268 | 24 | 12-ø22 | 173 | 360 | 310 | 278 | 30 | 12-ø26 | 178 | 375 | 320 | 285 | 34 | 12-ø30 | 181 | |
| 250 | 730 | 550 | 775 | 1132 | 405 | 355 | 320 | 26 | 12-ø26 | 277 | 425 | 370 | 335 | 32 | 12-ø30 | 283 | 450 | 385 | 345 | 38 | 12-ø33 | 288 | |
| 300 | 850 | 600 | 852 | 1528 | 460 | 410 | 378 | 28 | 12-ø26 | 400 | 485 | 430 | 395 | 34 | 16-ø30 | 411 | 515 | 450 | 410 | 42 | 16-ø33 | 420 | |
| 350 | 980 | 700 | 1005 | 2146 | 520 | 470 | 438 | 30 | 16-ø22 | 440 | 555 | 490 | 450 | 38 | 16-ø33 | 465 | 580 | 510 | 465 | 46 | 16-ø36 | 490 | |
| 400 | 1100 | 700 | 1140 | 2790 | 580 | 525 | 490 | 32 | 16-ø30 | 730 | 620 | 550 | 505 | 40 | 16-ø36 | 760 | 660 | 585 | 535 | 50 | 16-ø39 | 790 | |

Data given can be changed without notice

Edition 10/2017

Phone: 031-8035-6980/ 010-2623-7827
 E-mail: Juwonsolution@gmail.com
 Juwonsteel.cafe24.com

압력-온도표



PRESSURE-TEMPERATURE RATINGS

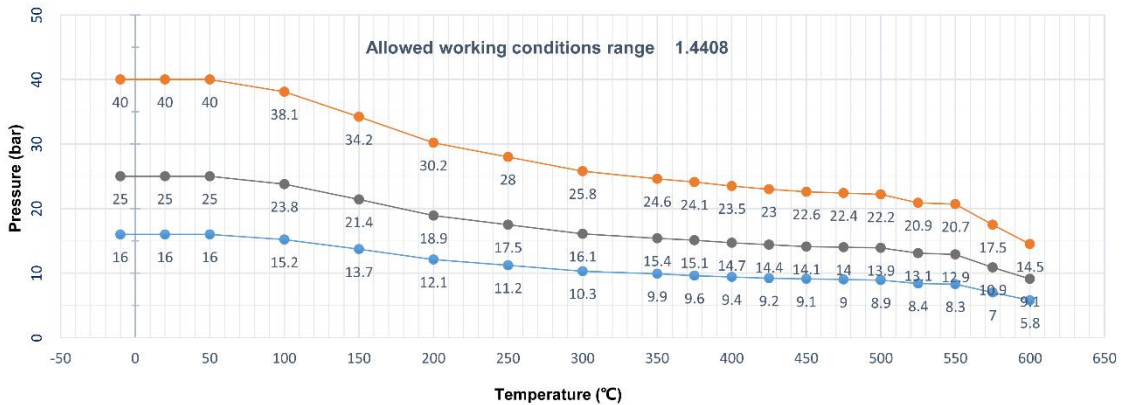
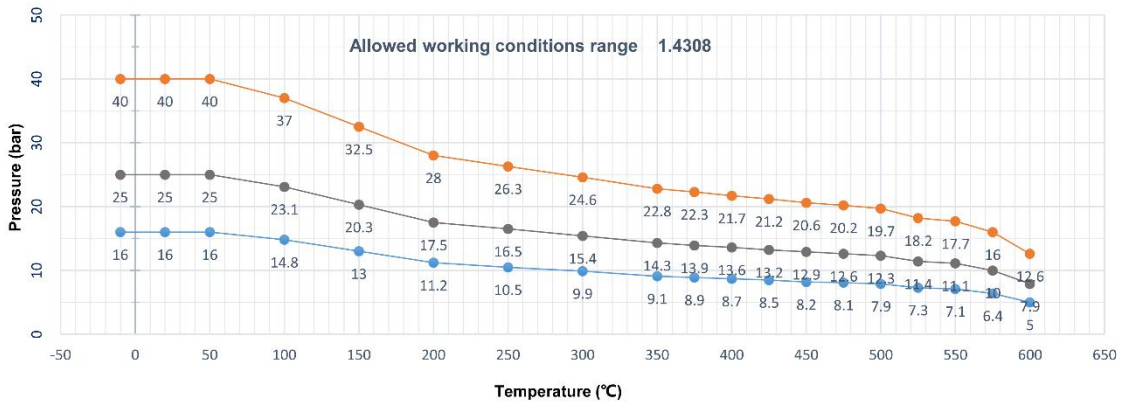
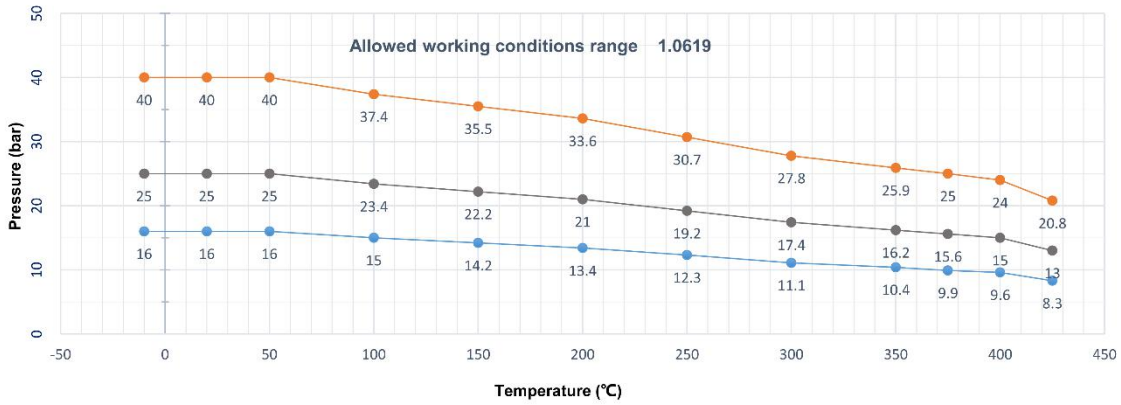
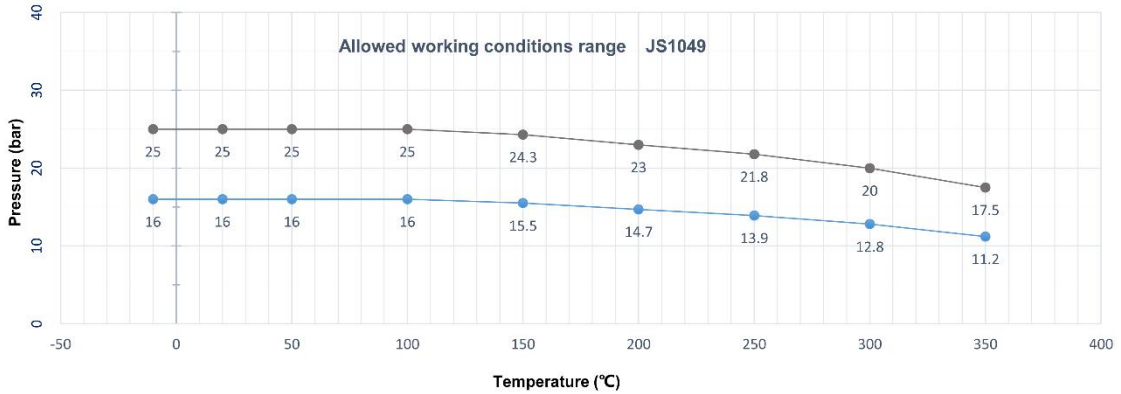

Data given can be changed without notice

Edition 10/2017

MORE FUNCTION OPTIONS

- Conical disc
- Flat disc
- Soft disc
- Stop-check disc
- Balance type disc
- Window shape disc
- Impact wheel operator
- Gear operator
- Pneumatic actuator
- Electric actuator
- Position indicator
- Limit switches
- BW ends
- JIS connections
- ANSI connections